

# CUTTER INSTALLATION GUIDE

Use these instructions with the Avery Dennison® Monarch® Tabletop Printer 1 (ADTP1) and the optional Avery Dennison® 933 Cutter. You need a 3 mm ball-end, 5" long-leg hex key to complete this procedure.

**Caution:** Do not place your fingers or any other objects into the cutter.

## Installing the Cutter

---

The cutter must be installed on a level surface. **Turn off the printer** before you install the cutter.

1. Open the printer's exit cover.

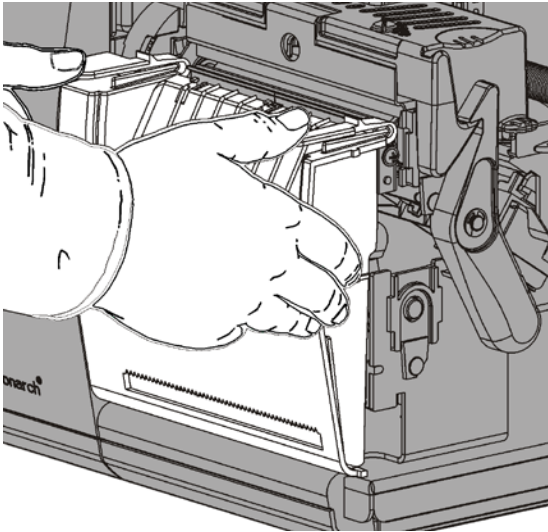

2. Remove the printer's exit cover; squeeze the sides together and pull out. The exit cover flexes when squeezed.

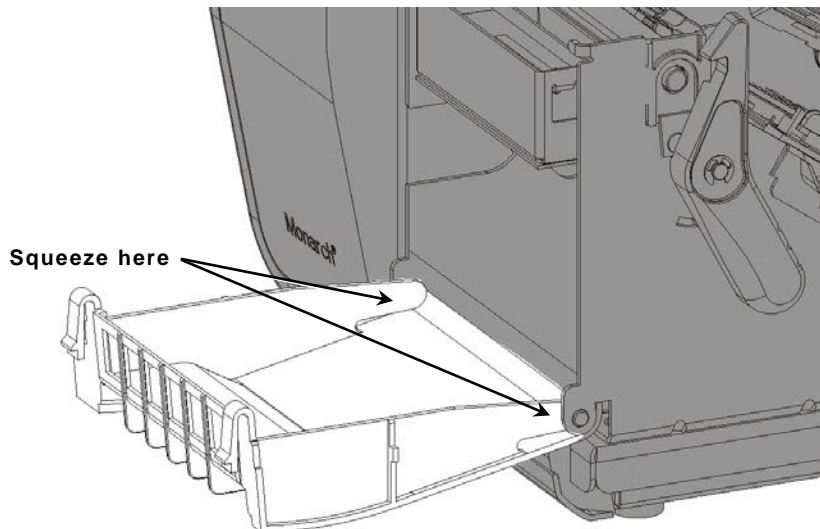

3. Attach both of the printer's connectors to both of the cutter's connectors. **Ensure both connections are securely attached to one another.**
4. Open the cutter's exit door. Lift at the finger notch and rotate the door all the way open.
5. Align the cutter bracket's mounting holes with the printer's mounting screws. Once the screws are in the holes, drop the cutter into place. The bottom of the cutter bracket rests on the printer mounting hook(s).
6. Use the hex screwdriver to tighten the two mounting screws. Be sure the cutter is centered in the printer's opening and does not pivot or rotate.

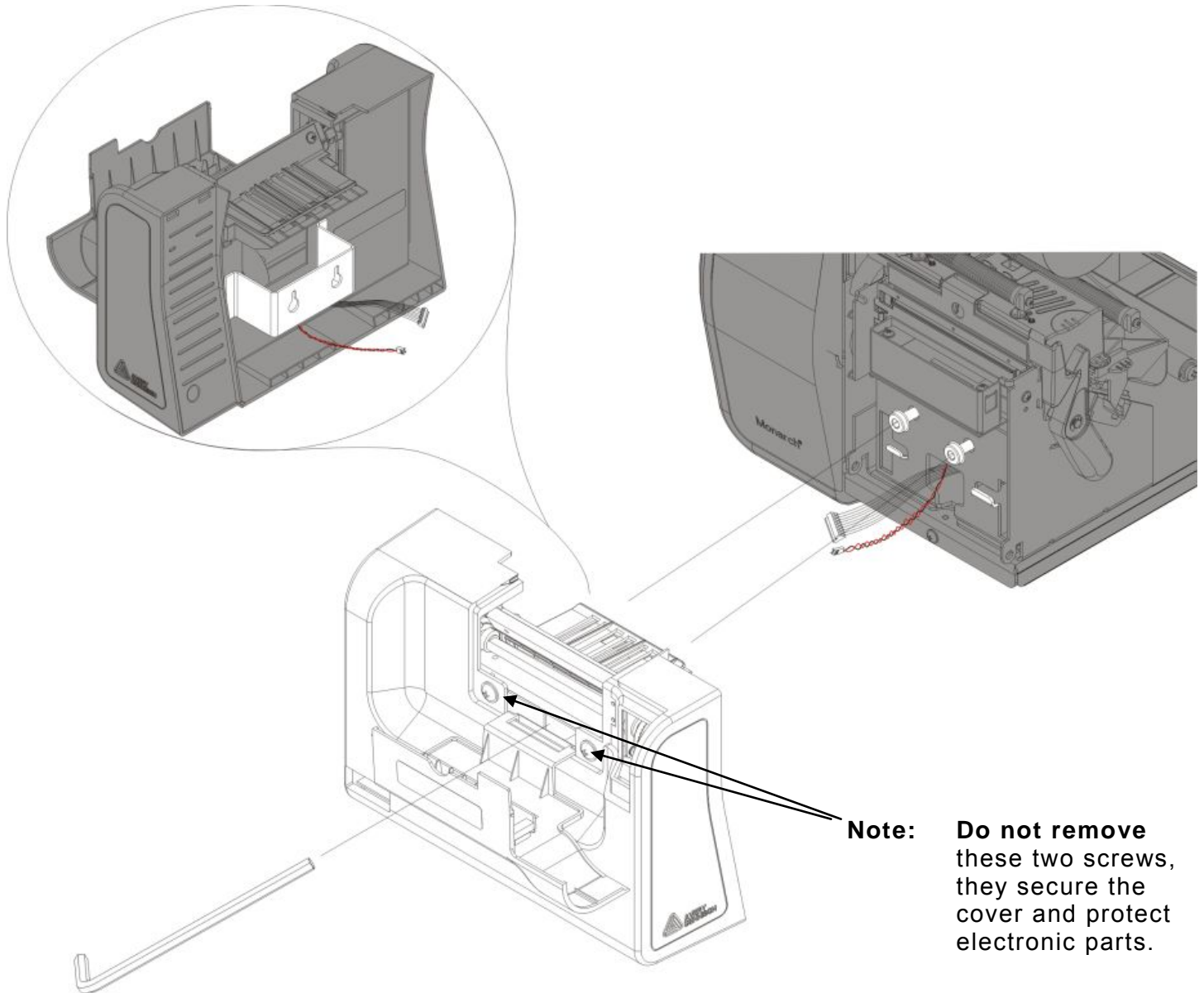

7. Close the cutter door.

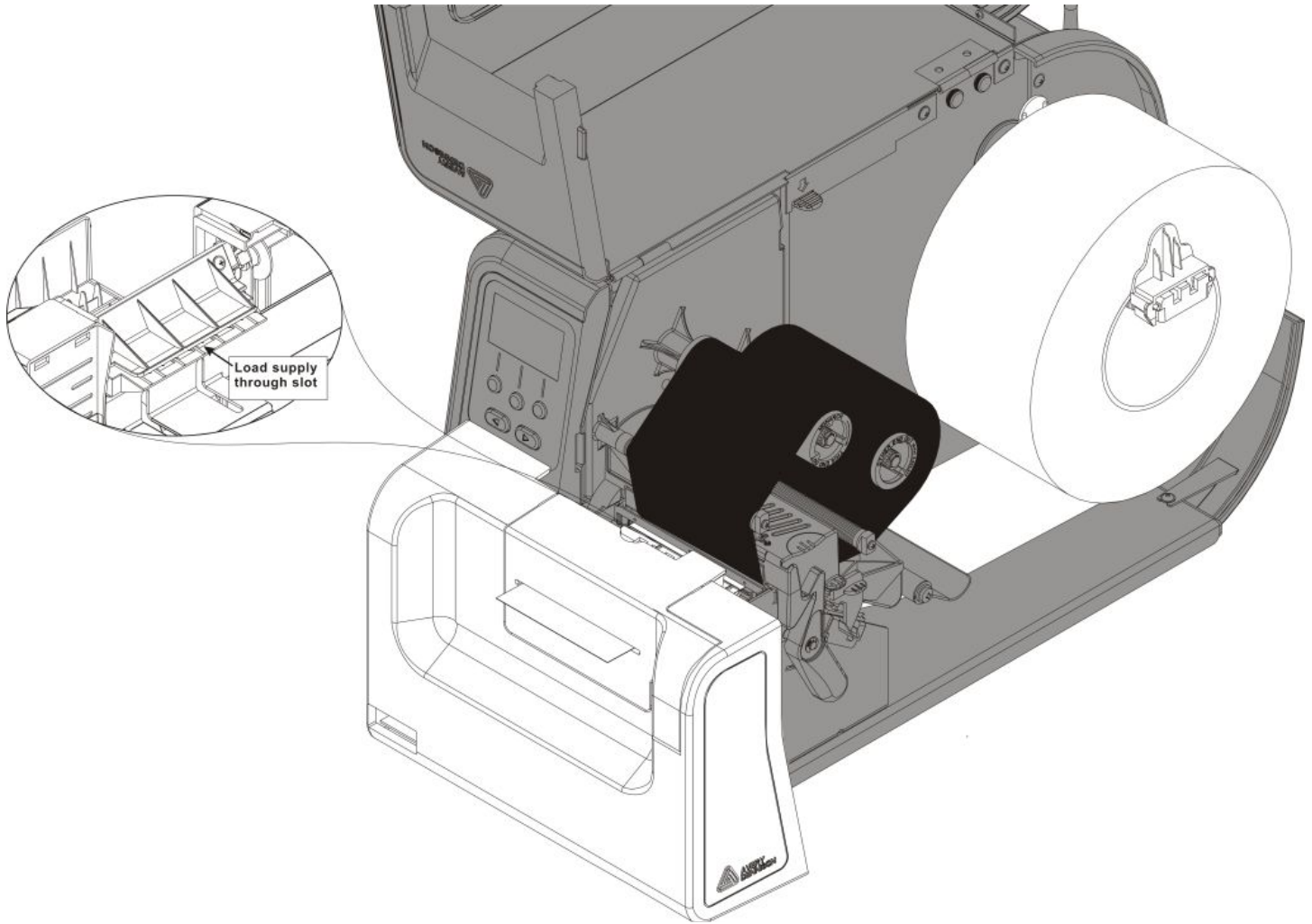

8. Load supply. Refer to the Operator's Handbook for additional supply loading information.

9. Turn on the printer.

## Special Considerations

---

When using the cutter, note the following items:

- ◆ The cutter door has a safety interlock; the cutter will not engage or cut if the door is open.
- ◆ The maximum print speed using the cutter is 8.0 inches per second.
- ◆ For 1.2 inch (mm) supply, the maximum print speed is 6.0 ips.

### Cutting with an RFID Printer

- ◆ The minimum cut width is 1.5 inches (38 mm); the minimum cut length is 1.5 inches (38 mm).
- ◆ Use only Monarch® approved RFID tag supplies.
- ◆ The cutter can cut Avery Dennison tags up to 15 mils thick only for RFID applications.

## Supply Specifications

---

<b>Widths:</b>	0.75 to 4.0 inches (19 mm to 102 mm)
<b>Lengths:</b>	0.75 inches (19 mm) without cutting 1.2 to 16.0 inches (30 mm to 406 mm) with cutting
	<b>Note:</b> Maximum cut tag length using the stacker is 3.66 inches (93 mm).
<b>Thickness:</b>	Tags: 0.0095" – 0.012" (0.2413 - 0.3048 mm) Labels: 0.002" – 0.007" (0.0508 - 0.1778 mm) RFID Tags: 0.013" – 0.015" (0.3302 - 0.381 mm)
<b>Batch Separator:</b>	3.66 inches (93 mm)
<b>Warranty:</b>	cutting tags – one year or 1,000,000 cuts, whichever occurs first cutting labels - one year or 500,000 cuts, whichever occurs first cutting RFID tags – one year or 500,000 cuts, whichever occurs first

## Clearing a Cutter Jam

---

If tags are jammed in the cutter, the printer shows error 760.

If you are using a stacker, you may need to disconnect the stacker from the cutter in order to clear a jam.

1. Turn off the printer.
2. Open the cutter's door. Lift at the finger notch and rotate until fully open. The cutter does not cut with the door open.
3. Clear the tag path by using a tool, such as a screwdriver or needle-nose pliers, to pull the jammed tags out of the cutter.  
Rotate the cutter forward or backward to release any jammed tags by placing your finger against the belt and pulley, then move the pulley up or down to move the cutter.

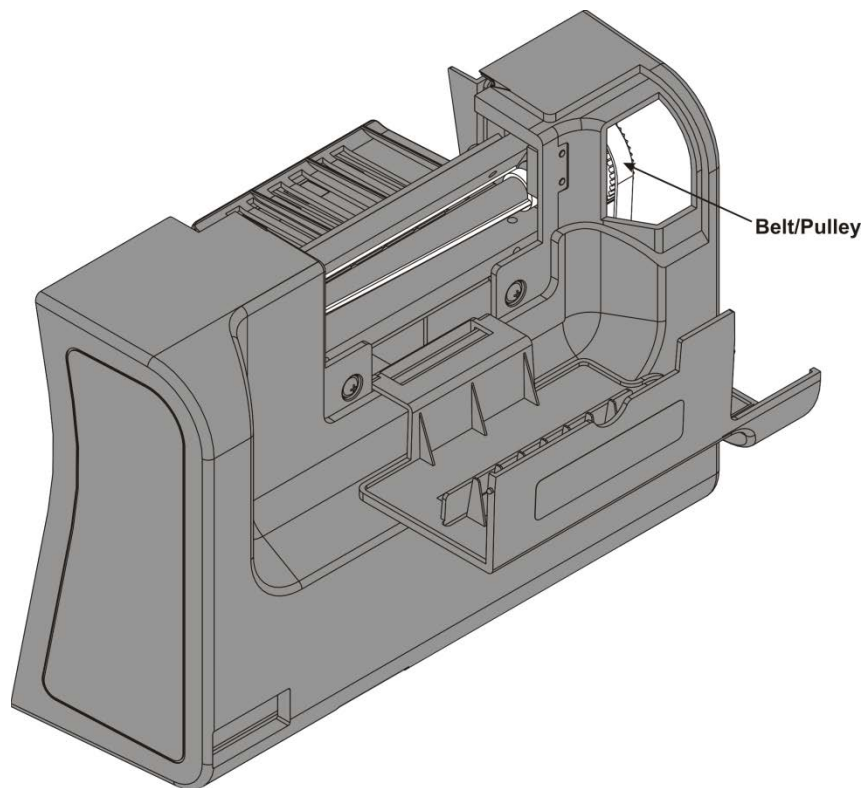

**Caution:** Do not place your fingers near the cutter's blade.  
Do not use excessive force to remove tags; this may damage the cutter.

4. Turn on the printer. Send a test batch of tags to the printer.

## Cleaning & Lubricating the Cutter

We recommend cleaning and lubricating the cutter after 15 rolls of supply or 100,000 cuts. Use only lithium grease to clean and lubricate.

**Caution:** Do not use alcohol, solvents, or degreasers on the cutter.

1. Turn off the printer.
2. Open the cutter's door. Lift at the finger notch and rotate until fully open. The cutter does not cut with the door open.
3. Lightly coat a long cotton swab with lithium grease. Gently move the cotton swab back and forth along the stationary and rotating cutting surfaces until all adhesive is removed.

**Note:** Place your finger against the exposed belt/pulley, then move the pulley up or down to move the rotating cutter surface.

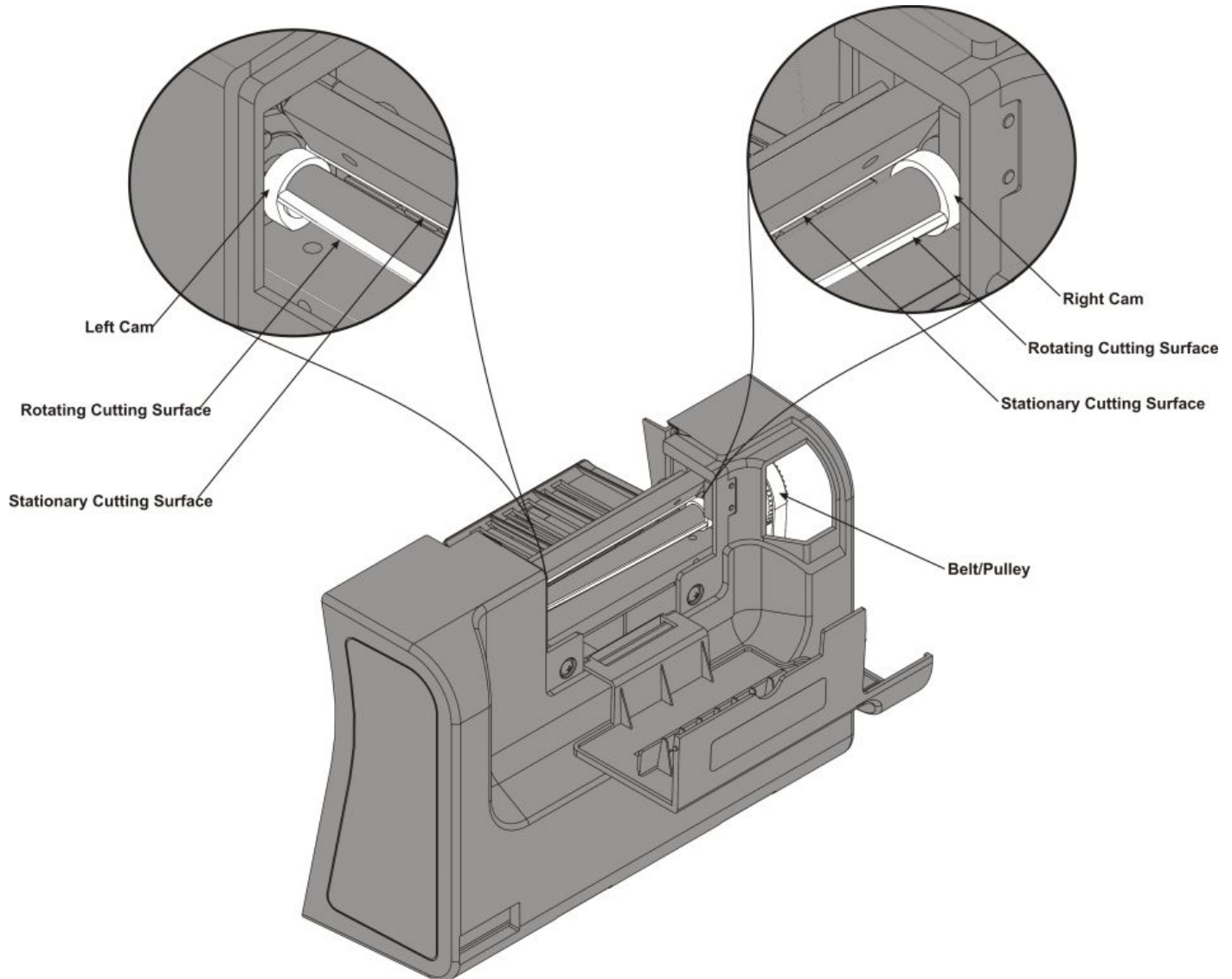

4. Lightly coat another long cotton swab with lithium grease. Gently move the cotton swab along each of the two cams (left side and right side).

**Caution:** Do not place your fingers near the cutting surfaces.

5. Close the cutter's door.
6. Turn on the printer.
7. Print a small batch of test tags to remove any remaining grease.

